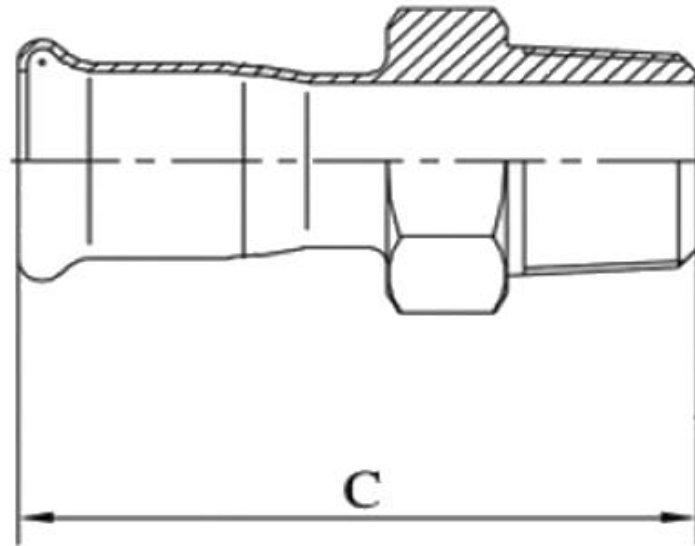

**CRIZTO SINGAPORE PTE LTD**

10 Tampines North Drive 4 #04-08/09/10/11  
 JTC Space @ Tampines North Singapore 528553  
 T: +65 6287 5287 | F: +65 6287 9287 | E: sales@crizto.com  
 W: www.crizto.com | www.facebook.com/CriztoSingapore

**CRIZTO**<sup>®</sup>  
*a beautiful bathroom speaks well of its owner,  
 make yours speak for you!™*

**SANITARY WARE SPECIFICATIONS & TECHNICAL DRAWINGS**

CODE	Description	OD	C
CPF-SFMI-15X15	15mm X 1/2" Socket FMI	15X1/2"	52
CPF-SFMI-15X22	15mm X 3/4" Socket FMI	15X3/4"	53
CPF-SFMI-22X15	22mm X 1/2" Socket FMI	22X1/2"	53
CPF-SFMI-22X22	22mm X 3/4" Socket FMI	22X3/4"	53



MODEL NO.

**CPF-SFMI**

SERIES

**FITTINGS**

DESCRIPTION

UNION SOCKET FMI

DIMENSION

SCALE

DATE

01-02-2021

DRAWING NO.

CPF-SFMI-01